



SFC offers a wide range of end connectors that will enhance your application.

Manufactured from a range of finishes and materials including **nylon**, **steel**, **stainless steel** and **zinc**, they will give many years of trouble free operation.

End fittings or end connectors can be both the same or you can choose different sizes and types for each end. Flexibility is what SFC offers you

Nylon Ball Joints

	P1	P2	P5	P7	P8	PA
J (+/-)	9.0mm 0.5mm	14.0mm 0.5mm	12.0mm 0.5mm	NO PIN	NO PIN	14.0mm 0.5mm
K (+/-)	10.3mm 0.25mm	9.0mm 0.2mm	12.5mm 0.25mm	NO PIN	NO PIN	9.0mm 0.2mm
G	M5 x 0.8	M5 x 0.8	M8 x 1.25	NO PIN	NO PIN	M5 x 0.8
C	M5 x 0.8	M5 x 0.8	M6 x 1.0	M5 x 0.8	M6 x 1.0	M6 x 1.0
L (+/-)	17.5mm 0.5mm	17.5mm 0.5mm	17.5mm 0.5mm	17.5mm 0.5mm	17.5mm 0.5mm	17.5mm 0.5mm

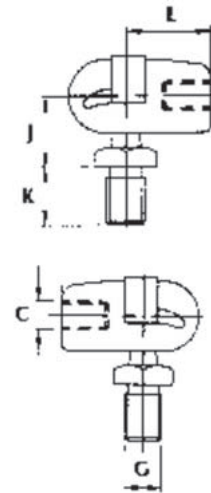

Nylon Eyes

	E1	E2	E3	E4	E5
E (+/-)	6.1mm 0.08mm	7.35mm 0.05mm	8.1mm 0.05mm	6.1mm 0.05mm	10.1mm 0.05mm
M (+/-)	8.1mm 0.05mm	7.0mm 0.2mm	10.0mm 0.12mm	10.0mm 0.12mm	10.0mm 0.12mm
L (+/-)	17.0mm 0.5mm	17.0mm 0.5mm	21.0mm 0.25mm	21.0mm 0.25mm	21.0mm 0.25mm
C	M5 x 0.8	M5 x 0.8	M6 x 1.0	M6 x 1.0	M6 x 1.0

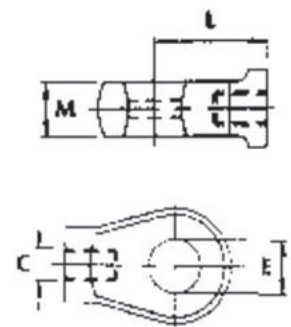

Flat Steel Eyes

	F1	F2	F3	F4	FD
E (+/-)	6.1mm 0.12mm	8.1mm 0.12mm	10.2mm 0.12mm	8.2mm 0.12mm	10.0mm 0.12mm
M (+/-)	3.0mm 0.12mm	5.0mm 0.12mm	5.0mm 0.12mm	8.0mm 0.12mm	10.0mm 0.12mm
L (+/-)	22.0mm 0.25mm	25.0mm 0.25mm	25.0mm 0.25mm	32.0mm 0.25mm	32.0mm 0.25mm
C	M5 x 0.8	M6 x 1.0	M6 x 1.0	M8 x 1.25	M10 x 1.5

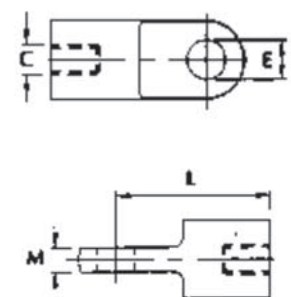

Steel Clevis Forks

	C1	C2	C3	C4
E (+/-)	5.0mm 0.25mm	6.0mm 0.25mm	8.0mm 0.25mm	10.0mm 0.25mm
M (+/-)	5.14mm 0.12mm	6.15mm 0.12mm	8.15mm 0.12mm	10.15mm 0.12mm
L (+/-)	20.0mm 0.5mm	24.0mm 0.5mm	32.0mm 0.5mm	37.0mm 0.5mm
C	M5 x 0.8	M6 x 1.0	M8 x 1.25	M10 x 1.5

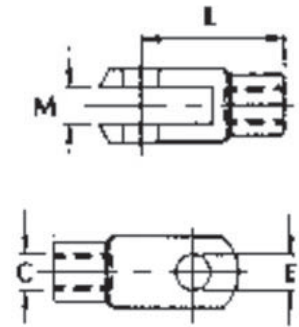

Steel Ball Joints

mm's	B1	B2	B3	B4	B5	B6	B8	B9
J (+/-)	12.0 0.5	12.0 0.5	12.0 0.5	13.0 0.2	13.0 0.2	16.0 0.25	NO PIN	NO PIN
K (+/-)	9.0 0.3	12.5 0.5	12.5 0.5	16.5 0.5	16.5 0.5	20.0 0.5	NO PIN	NO PIN
G	M5 x 0.8	M8 x 1.25	5/16" UNC	M8 x 1.25	5/16" UNC	M10 x 1.5	NO PIN	NO PIN
L (+/-)	18.0 0.25	18.0 0.25	18.0 0.25	30.0 0.25	30.0 0.25	35.0 0.3	18.0 0.25	30.0 0.25
C	M6 x 1.0	M6 x 1.0	M6 x 1.0	M8 x 1.25	M8 x 1.25	M10 x 1.5	M6 x 1.0	M8 x 1.25

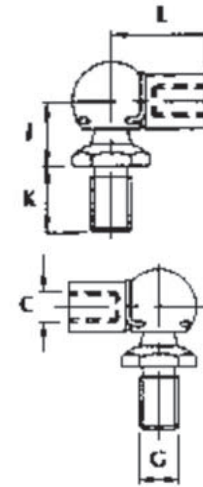

Zinc Eyes

	Z2	Z3	Z4	Z5
E (+/-)	8.3mm 0.1mm	10.3mm 0.1mm	8.3mm 0.1mm	10.3mm 0.1mm
M (+/-)	10.0mm 0.12mm	10.0mm 0.12mm	10.0mm 0.12mm	10.0mm 0.12mm
L (+/-)	21.0mm 0.25mm	21.0mm 0.25mm	21.0mm 0.25mm	21.0mm 0.25mm
C	M6 x 1.0	M6 x 1.0	M8 x 1.25	M8 x 1.25

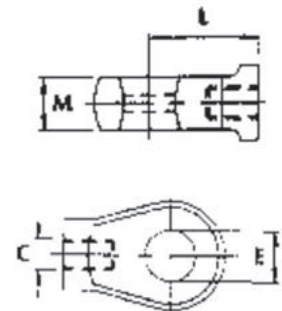

	S1	S4	S6	S8
M	M8 x 1.25	M10 x 1.5	M5 x 0.8	M6 x 1.0
L	12mm	12mm	10mm	10mm
Standard ∅	10-23	14-28	6-15	8-18

